

THERMACUT® REPLACEMENT PARTS SUITABLE FOR TRAFIMET® A140™/P140™

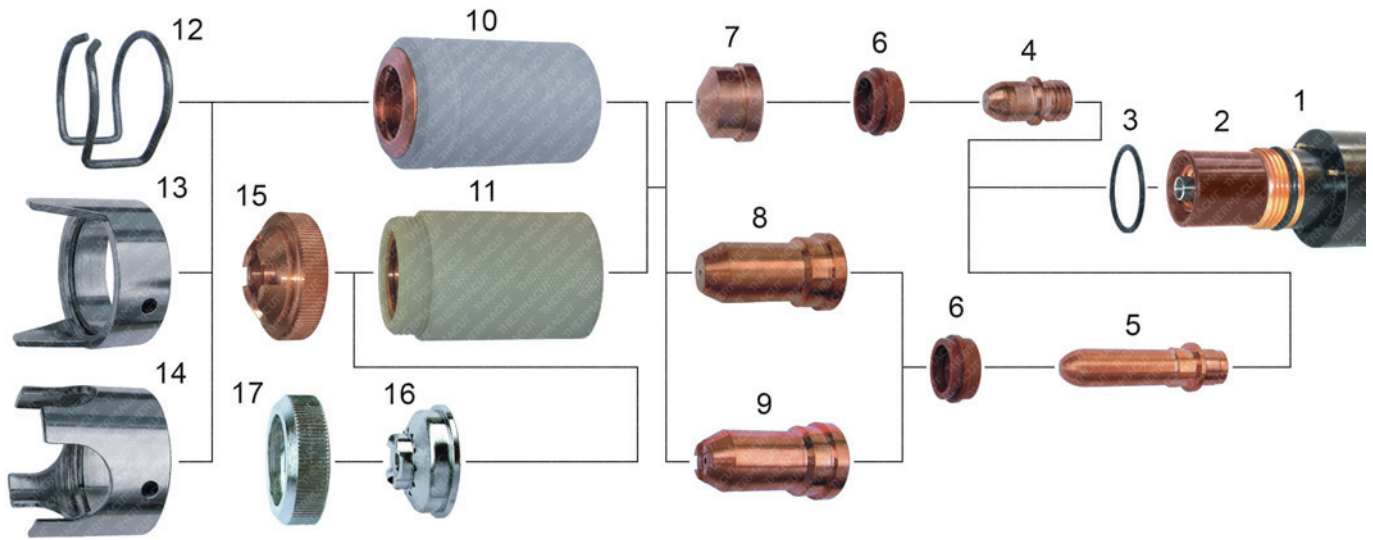

Item	Part No.	Ref. No.	Description	Std. Pkg.	Item	Part No.	Ref. No.	Description	Std. Pkg.
1.	TN-0109	PF101	Torch Body, Hand	1	11.	T-5013	PC103	Contact Nozzle Ret. Cap	1
	TN-0106	PF102	Torch Body, Machine	1	12.	T-3718	CV11	Spacer Spring	5
2.	T-11114	60080	Insulator brown (present torch design with brown insulator)	1	13.	T-0643	CV12(1408)	Double Pointed Spacer	1
3.	T-3562	EA131	O-Ring	1	14.	T-5003	CV14	Crown Spacer	6
4.	T-5059	PR101	Electrode	10	15.	T-5004	CV23	Shield Cup	6
5.	T-5065	PR116	Electrode, Long - no thread	5	16.	T-9370		Spacer for Contact Cutting	1
6.	T-5072	PE101	Swirl Ring	2	17.	T-9375		Locking Nut	1
7.	T-2926	PD101-11	Nozzle 1.1mm	5	NS	T-5069	TP12	Insulating Sleeve	1
	T-3349	PD101-14	Nozzle 1.4mm	5	NS	T-5068	TP10	Handle with Switch	1
	T-2955	PD101-17	Nozzle 1.7mm	5	NS	KT-1100	PH148	A140™ Cable Leads 6m, Hand, fittings	1
	T-2954	PD101-19	Nozzle 1.9mm	5	NS	KT-1219	PA101	A140™ Hand Torch with Leads 6m, fittings	1
8.	T-5032	PD117-14	Nozzle 1.4mm, Long	10	NS	KT-1050	PA214	A140™ Hand Torch with Leads 6m, centr.conn.	1
	T-5033	PD117-17	Nozzle 1.7mm, Long	10	NS	KT-1053	PA219	A140™ Hand Torch with Leads 12m, centr.conn.	1
	T-5034	PD117-19	Nozzle 1.9mm, Long	10	NS	KT-1260	KP140-M,8,5M.CCK	P140™ Cable Leads 8.5m, Hand/Mach., fittings	1
9.	T-9527	PD111	Nozzle, Gouging	1	NS	KT-1119	PA146	P140™ Mach. Torch with Leads 12m, centr.conn.	1
10.	T-10409	PC101	Nozzle Retaining Cap	1					

NS NOT SHOWN IN THE PICTURE

Last update of this page: 01/11/2020. See Revision history for details.

THERMACUT®
THE CUTTING COMPANY

WWW.THERMACUT.CZ
TEL.: +420.556 423 418
SALES@THERMACUT.CZ

WWW.THERMACUT.DE
TEL.: +49 (0) 27 39 40 33 0
INFO@THERMACUT.DE

WWW.THERMACUT.COM
TEL.: 1-603-542-6715
CUSTOMERSERVICE@THERMACUT.COM

THERMACUT®, THE CUTTING COMPANY®, FHT-EX®, EX-TRAFIRE®, EX-TRACK®, EX-TRABEAM® AND EX-TRAFLEAME® ARE REGISTERED TRADEMARKS OF THERMACUT, K.S. AND MAY BE REGISTERED IN CZECH REPUBLIC AND/OR OTHER COUNTRIES. ALL OTHER TRADEMARKS ARE PROPERTIES OF THEIR RESPECTIVE OWNERS. THERMACUT IS NO WAY AFFILIATED WITH TRAFIMET®. MOST THERMACUT PARTS ARE MADE FOR OR BY AN IBC COMPANY. PARTS INDICATED WITH A OEM ARE ORIGINAL PARTS MANUFACTURED BY THE ABOVE NAMED MANUFACTURER AND ARE BEING RESOLD BY THERMACUT. THERMACUT RESERVES THE RIGHT TO SUBSTITUTE OEM PARTS IN PLACE OF THERMACUT PARTS. VALID FROM NOVEMBER 2020 • PREVIOUS VERSION IS NO LONGER VALID. • © COPYRIGHT 2020 BY THERMACUT® CZECH REPUBLIC. ALL RIGHTS RESERVED.