

THERMACUT® REPLACEMENT PARTS SUITABLE FOR KJELLBERG®

**HiFocus® 280 / HiFocus® 360, HiFocus® 440
PerCut® 370.1, PerCut® 370.2**

REPLACEMENT PARTS SUITABLE FOR PerCut® 370.1

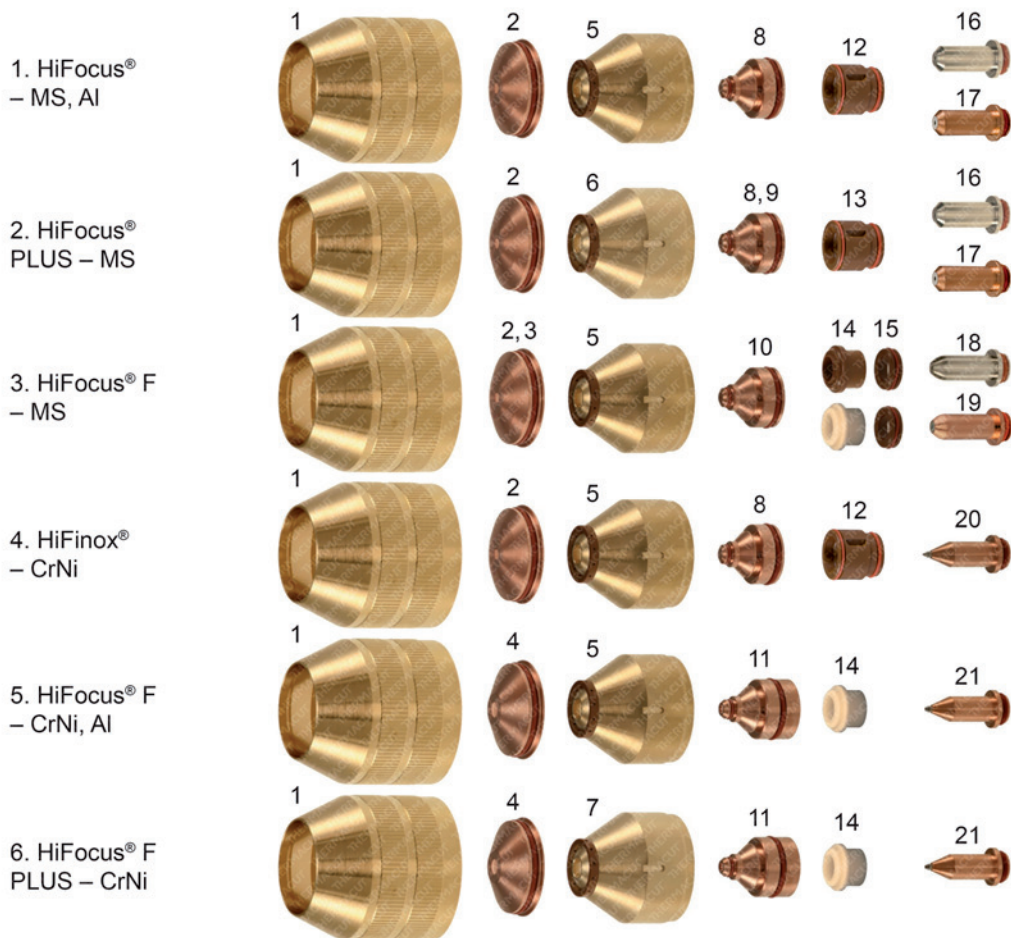

REPLACEMENT PARTS SUITABLE FOR PerCut® 370.2

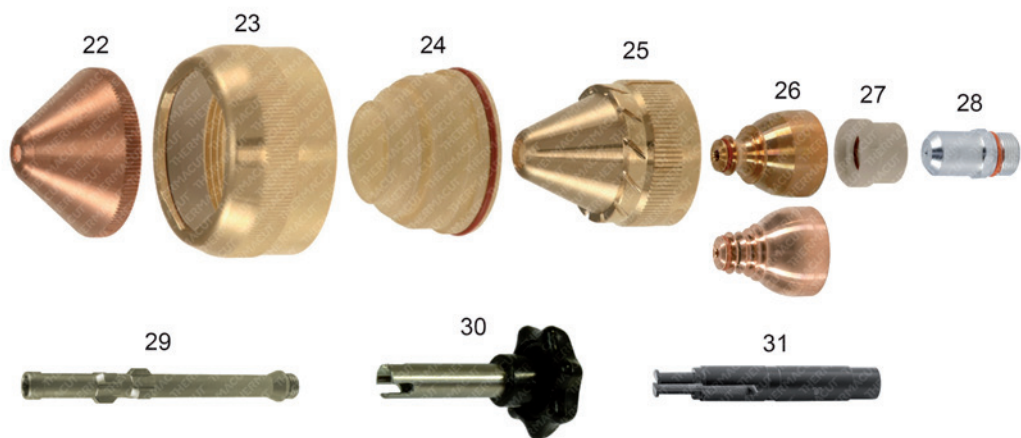

Last update of this page: 12/05/2020. See Revision history for details.

THERMACUT®
THE CUTTING COMPANY

WWW.THERMACUT.CZ
TEL.: +420 556 423 418
SALES@THERMACUT.CZ

WWW.THERMACUT.DE
TEL.: +49 (0) 27 39 40 33 0
INFO@THERMACUT.DE

WWW.THERMACUT.COM
TEL.: 1-603-542-6715
CUSTOMERSERVICE@THERMACUT.COM

THERMACUT®, THE CUTTING COMPANY®, FHT-EX®, EX-TRAFIRE®, EX-TRACK®, EX-TRABEAM® AND EX-TRAFLEAME® ARE REGISTERED TRADEMARKS OF THERMACUT, K.S. AND MAY BE REGISTERED IN CZECH REPUBLIC AND/OR OTHER COUNTRIES. ALL OTHER TRADEMARKS ARE PROPERTIES OF THEIR RESPECTIVE OWNERS. THERMACUT IS NO WAY AFFILIATED WITH KJELLBERG®.
MOST THERMACUT PARTS ARE MADE FOR OR BY AN IBC COMPANY. PARTS INDICATED WITH A OEM ARE ORIGINAL PARTS MANUFACTURED BY THE ABOVE NAMED MANUFACTURER AND ARE BEING RESOLD BY THERMACUT. THERMACUT RESERVES THE RIGHT TO SUBSTITUTE OEM PARTS IN PLACE OF THERMACUT PARTS.
VALID FROM NOVEMBER 2020 • PREVIOUS VERSION IS NO LONGER VALID. • © COPYRIGHT 2020 BY THERMACUT® CZECH REPUBLIC. ALL RIGHTS RESERVED.

THERMACUT® REPLACEMENT PARTS SUITABLE FOR KJELLBERG®

HiFocus® 280 / HiFocus® 360, HiFocus® 440 PerCut® 370.1, PerCut® 370.2

REPLACEMENT PARTS SUITABLE FOR PerCut® 370.1

Item	Part No.	Ref. No.	Sh.Ref.No.	Description	Std. Pkg.	Item	Part No.	Ref. No.	Sh.Ref.No.	Description	Std. Pkg.
1.	T-8630	11.835.201.081	Z501	Protection Cap	1		T-10006	11.843.021.414	S2014X	Nozzle 1.4 130/160A	10
2.	T-8631	11.835.201.1561	Z4015	Swirl Gas Cap 1.5	10		T-10007	11.843.021.416	S2016X	Nozzle 1.6 160A	10
	T-8632	11.835.201.1571	Z4020	Swirl Gas Cap 2.0	10	10.	T-10008	11.843.121.412	S2112X	Nozzle 1.2 100A	10
	T-8885	11.835.201.1551	Z4022	Swirl Gas Cap 2.2	10		T-10009	11.843.121.414	S2114X	Nozzle 1.4 130A	10
	T-8633	11.835.201.1581	Z4025	Swirl Gas Cap 2.5	10		T-10010	11.843.121.416	S2116X	Nozzle 1.6 160A	10
	T-8634	11.835.201.1591	Z4030	Swirl Gas Cap 3.0	10	11.	T-10011	11.843.111.614	S2514X	Nozzle 1.4 120A	5
3.	T-8650	11.835.401.1571	Z4140	Swirl Gas Cap 4.0	10		T-9926	11.843.111.616	S2516X	Nozzle 1.6 140A	5
4.	T-9928	11.835.411.1581	Z4530	Swirl Gas Cap 3.0	10		T-9927	11.843.111.618	S2518X	Nozzle 1.8 160A	5
	T-10153	11.835.411.1580	Z4535	Swirl Gas Cap 3.5	1	12.	T-8623	11.835.221.153	Z101	Swirl Ring 0.4 (3×CW)	1
	T-9929	11.835.411.1591	Z4540	Swirl Gas Cap 4.0	10	13.	T-8886	11.835.221.154	Z102	Swirl Ring 0.4 (2×CW)	1
5.	T-8887	11.842.401.160	S3004	Nozzle Cap 0.4	1	14.	T-9287	11.834.321.153K	Z111	Swirl Ring, Ceramic	1
	T-8888	11.842.401.162	S3008	Nozzle Cap 0.8	1		T-8618	11.834.321.153	Z111	Swirl Ring, Vespel	1
6.	T-8889	11.842.401.1622	S3028	Nozzle Cap 0.8	1		T-10380	11.834.321.153 OEM	Z111	Swirl Ring	1
	T-10208	11.842.401.1624	S3048	Nozzle Cap 0.8	1	15.	T-8655	11.835.421.303	Z111A	Spacer	2
7.	T-10328	11.842.401.1621	S3018	Nozzle Cap 0.8	1	16.	T-4920	11.843.021.320-AG	S002Y	Cathode, SilverEX®	5
8.	T-10000	11.843.021.406	S2006X	Nozzle 0.6 25A	10	17.	T-11204**	11.843.021.320-PRO	S002Y	Cathode, Silver PRO	5
	T-10001	11.843.021.407	S2007X	Nozzle 0.7 35A	10	18.	T-4924	11.843.121.310-AG	S012X	Cathode, SilverEX®	5
9.	T-10002	11.843.021.408	S2008X	Nozzle 0.8 50/60A	10	19.	T-11853**	11.843.121.310-PRO	S012X	Cathode, Silver PRO	5
	T-10003	11.843.021.409	S2009X	Nozzle 0.9 70/80A	10	20.	T-9924	11.842.411.510	S042	Cathode, HiFinox™ (i)	5
	T-10004	11.843.021.410	S2010X	Nozzle 1.0 80/90A	10	21.	T-9925	11.842.511.510	S052	Cathode, FineFocus® (i)	5
	T-9699	11.843.021.411	S2011X	Nozzle 1.1 90/100A	10	31.	T-11322	12.40320		Wrench for Swirl Ring	1
	T-10005	11.843.021.412	S2012X	Nozzle 1.2 100/130A	10						

REPLACEMENT PARTS SUITABLE FOR PerCut® 370.2

Item	Part No.	Ref. No.	Sh.Ref.No.	Description	Std. Pkg.	Item	Part No.	Ref. No.	Sh.Ref.No.	Description	Std. Pkg.
22.	T-10591	11.833.101.1550	V4330	Swirl Gas Cap 3.0	1		T-10562	11.846.921.427	T2127Y	Nozzle 300A, O ₂ , repl. 11.836.921.427 (i)	10
	T-10220	11.833.101.155	V4335	Swirl Gas Cap 3.5	1		T-10563	11.846.921.430	T2130Y	Nozzle 360A, O ₂ , repl. 11.836.921.430 (i)	10
	T-10221	11.833.101.156	V4340	Swirl Gas Cap 4.0	1		T-10927**	11.846.921.415-UR	T2115Y	Nozzle 120A, O ₂ , repl. 11.836.921.415	10
	T-10222	11.833.101.157	V4345	Swirl Gas Cap 4.5	1		T-10928**	11.846.921.420-UR	T2120Y	Nozzle 200A, O ₂ , repl. 11.836.921.420	10
	T-10223	11.833.101.158	V4350	Swirl Gas Cap 5.0	1		T-10929**	11.846.921.425-UR	T2125Y	Nozzle 250A, O ₂ , repl. 11.836.921.425	10
	T-10224	11.833.101.159	V4360	Swirl Gas Cap 6.0	1		T-10930**	11.846.921.427-UR	T2127Y	Nozzle 300A, O ₂ , repl. 11.836.921.427	10
NS	T-11810	11.833.111.159	V4560	Swirl Gas Cap 6.0	1		T-10931**	11.846.921.430-UR	T2130Y	Nozzle 360A, O ₂ , repl. 11.836.921.430	10
23.	T-10470	11.841.721.081	T502	Protection Cap PerCut® 370.2	1	27.	T-10466	11.836.921.1542	T104	Swirl Ring (3×0.4 CW)	1
24.	N-18267	11.836.921.271	T522	Insulator PerCut® 370.2	1		T-10366	11.836.921.153 OEM	T101	Swirl Ring (6×0.8 CW)	1
24a.	N-18371	N-18371		O-Ring	1		T-10672	11.836.921.153	T101	Swirl Ring (6×0.8 CW)	1
25.	T-10214	11.836.901.163	T3030	Nozzle Cap (12×1.5 30° CW)	1		T-10464	11.836.921.154	T102	Swirl Ring (3×0.8 CW)	5
	T-10215	11.836.901.164	T3045	Nozzle Cap (12×1.5 45° CW)	1		T-10465	11.836.921.1541	T112	Swirl Ring (3×0.8 CCW)	5
	T-10217	11.836.901.1641	T3145	Nozzle Cap (12×1.5 45° CCW)	1		TN-0004	11.836.921.153	T101	Swirl Ring (6×0.8 CW)	1
	T-10216	11.836.901.165	T3060	Nozzle Cap (12×1.5 60° CW)	1	*28.	T-10804*	11.844.921.300-AG	T012Y	Cathode, SilverEX®	5
26.	T-10559	11.846.921.415	T2115Y	Nozzle 120A, O ₂ , repl. 11.836.921.415 (i)	10	*29.	T-10558*	11.844.901.152	T902Y	Cooling Tube	1
	T-10560	11.846.921.420	T2120Y	Nozzle 200A, O ₂ , repl. 11.836.921.420 (i)	10	30.	T-10564	12.38180		Wrench for Cooling Tube	1
	T-10561	11.846.921.425	T2125Y	Nozzle 250A, O ₂ , repl. 11.836.921.425 (i)	10	31.	T-11322	12.40320		Wrench for Swirl Ring	1

(i) THIS PART MAY NOT BE DISTRIBUTED ON THE GERMAN MARKET. THERMACUT ACCEPTS NO RESPONSIBILITY IN CASE OF INDIRECT SALES TO GERMANY.

* FULLY INTERCHANGEABLE AND COMPATIBLE WITH ORIGINAL PARTS, BUT DIFFERS FROM ORIGINAL DESIGN

** A UNIQUE DESIGN WHICH ENHANCES PERFORMANCE AND DIFFERS FROM OEM DESIGNS

CCW COUNTER CLOCK WISE GAS SWIRLING, USE OF CCW PARTS WILL MAKE CUT ANGLE ON THE OPPOSITE SIDE, THAN WITH STANDARD CLOCK WISE (CW) SWIRLING PARTS.

-PRO TECHNOLOGY OF SILVER INSERTED COPPER ELECTRODE BODY, WHICH SIGNIFICANTLY DECREASES ELECTRODE COSTS WITH SIMILAR WORK PERFORMANCE COMPARED TO FULL SILVER ELECTRODES.

Last update of this page: 12/05/2020. See Revision history for details.

THERMACUT®
THE CUTTING COMPANY

WWW.THERMACUT.CZ
TEL.: +420.556.423.418
SALES@THERMACUT.CZ

WWW.THERMACUT.DE
TEL.: +49 (0) 27 39 40 33 0
INFO@THERMACUT.DE

WWW.THERMACUT.COM
TEL.: 1-603-542-6715
CUSTOMERSERVICE@THERMACUT.COM

THERMACUT®, THE CUTTING COMPANY®, FHT-EX®, EX-TRAFIRE®, EX-TRACK®, EX-TRABEAM® AND EX-TRAFAME® ARE REGISTERED TRADEMARKS OF THERMACUT, K.S. AND MAY BE REGISTERED IN CZECH REPUBLIC AND/OR OTHER COUNTRIES. ALL OTHER TRADEMARKS ARE PROPERTIES OF THEIR RESPECTIVE OWNERS. THERMACUT IS NO WAY AFFILIATED WITH KJELLBERG®.
MOST THERMACUT PARTS ARE MADE FOR OR BY AN IBG COMPANY. PARTS INDICATED WITH A OEM ARE ORIGINAL PARTS MANUFACTURED BY THE ABOVE NAMED MANUFACTURER AND ARE BEING RESOLD BY THERMACUT. THERMACUT RESERVES THE RIGHT TO SUBSTITUTE OEM PARTS IN PLACE OF THERMACUT PARTS.
VALID FROM NOVEMBER 2020 • PREVIOUS VERSION IS NO LONGER VALID. • © COPYRIGHT 2020 BY THERMACUT® CZECH REPUBLIC. ALL RIGHTS RESERVED.