

**THERMACUT® REPLACEMENT PARTS SUITABLE FOR  
CEBORA®  
HP100™, MP100™**

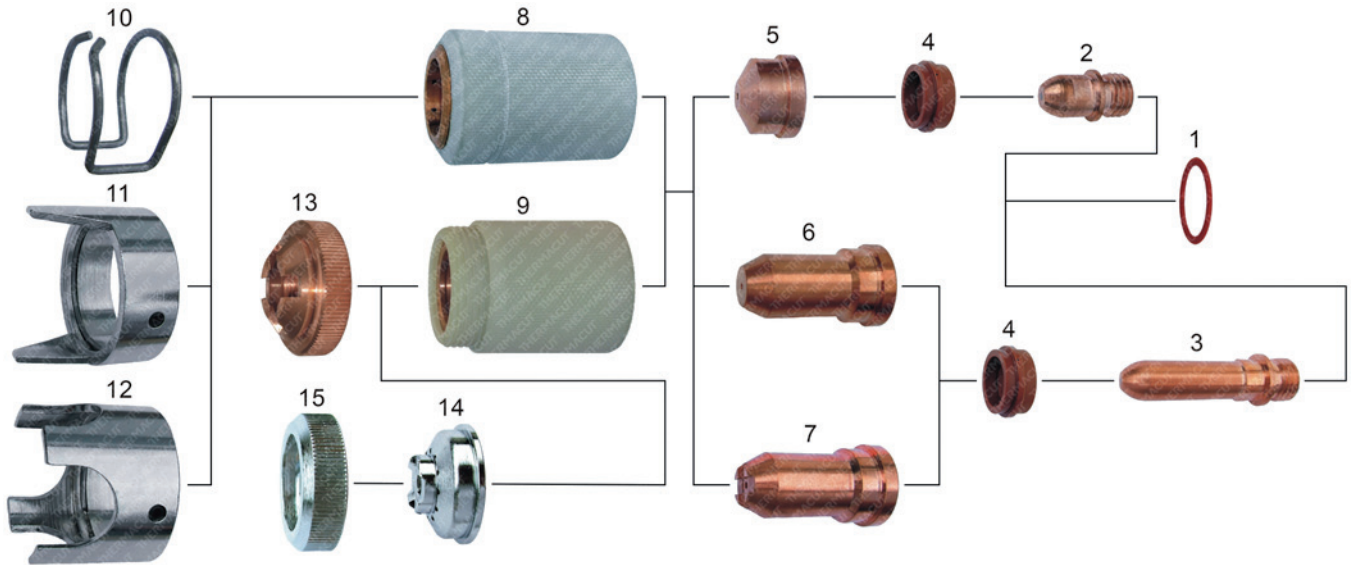

Item	Part No.	Ref. No.	Description	Item	Part No.	Ref. No.	Description
1.	T-0411	1398	O-Ring	7.	T-0406	1369	Nozzle, Long, Contact
2.	T-0408	1376	Electrode	8.	T-5432	W0300129	Retaining Cap
3.	T-0409	1517	Electrode, Long	9.	T-5433	W0300138	Contact Nozzle Retaining Cap
4.	T-0407	1377	Swirl Ring	10.	T-0400	1386	Spacer Spring
	T-8959	1377-CW	Swirl Ring	11.	T-0643	1408	Double Pointed Spacer
5.	T-0402	1371	Nozzle 1.1mm	12.	T-5003	CV14	Crown Spacer
	T-0403	1372	Nozzle 1.3mm	13.	T-5401	1392	Shield Cup, Only for W0300138
	T-0404	1373	Nozzle 1.6mm	NS	T-5442	1356	Handle with Switch
	T-0405	1374	Nozzle 1.8mm	14.	T-9370		Spacer for Contact Cutting
6.	T-11041	1369.16	Nozzle, Long D1.6 - 120A	15.	T-9375		Locking Nut

NS NOT SHOWN IN THE PICTURE

**Last update of this page: 24/02/2017. See Revision history for details.**

**THERMACUT®**  
THE CUTTING COMPANY

WWW.THERMACUT.CZ  
TEL.: +420 556 423 418  
SALES@THERMACUT.CZ

WWW.THERMACUT.DE  
TEL.: +49 (0) 27 39 40 33 0  
INFO@THERMACUT.DE

WWW.THERMACUT.COM  
TEL.: 1-603-542-6715  
CUSTOMERSERVICE@THERMACUT.COM

THERMACUT®, THE CUTTING COMPANY®, FHT-EX®, EX-TRAFIRE®, EX-TRACK®, EX-TRABEAM® AND EX-TRAFLEAME® ARE REGISTERED TRADEMARKS OF THERMACUT, K.S. AND MAY BE REGISTERED IN CZECH REPUBLIC AND/OR OTHER COUNTRIES. ALL OTHER TRADEMARKS ARE PROPERTIES OF THEIR RESPECTIVE OWNERS. THERMACUT IS NO WAY AFFILIATED WITH CEBORA®.  
MOST THERMACUT PARTS ARE MADE FOR OR BY AN IBG COMPANY. PARTS INDICATED WITH A OEM ARE ORIGINAL PARTS MANUFACTURED BY THE ABOVE NAMED MANUFACTURER AND ARE BEING RESOLD BY THERMACUT. THERMACUT RESERVES THE RIGHT TO SUBSTITUTE OEM PARTS IN PLACE OF THERMACUT PARTS.  
VALID FROM NOVEMBER 2020 • PREVIOUS VERSION IS NO LONGER VALID. • © COPYRIGHT 2020 BY THERMACUT® CZECH REPUBLIC. ALL RIGHTS RESERVED.