

THERMACUT® REPLACEMENT PARTS SUITABLE FOR CEBORA® CP®200

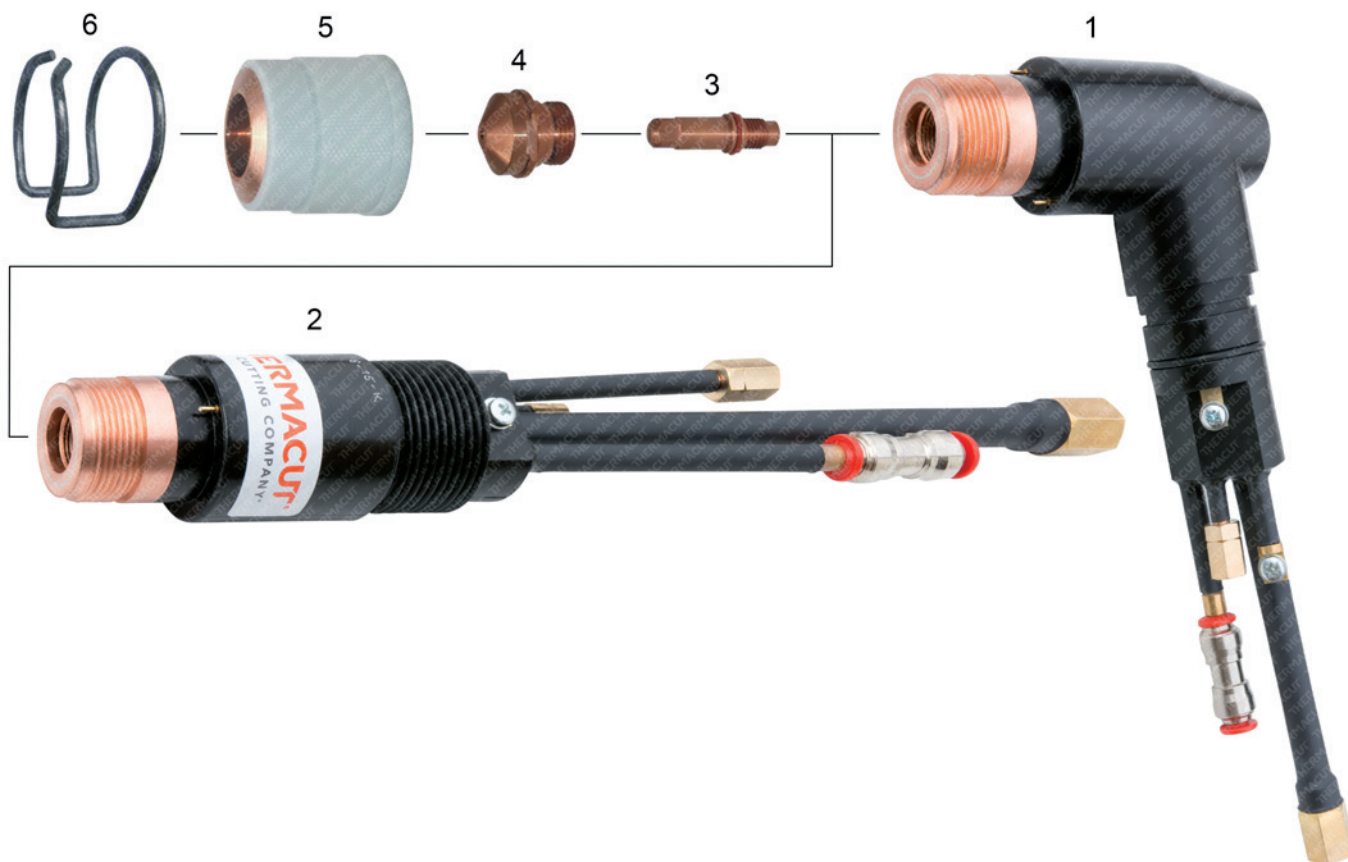

Item	Part No.	Ref. No.	Description	Item	Part No.	Ref. No.	Description
1.	T-11949	1355-UR	Hand Torch 70°	5.	T-5424	1905	Shield Cap
2.	T-11856	1357-UR	Machine Torch	6.	T-0400	1386	Spacer Spring
NS	PT-10455	1357-6	Cooling Tube	NS	KT-1319	1235	CP®200 Mach. Torch with Leads 4m, fittings
3.	T-9688	1367	Electrode	NS	KT-1320	K.CP200.4M.K	CP®200 Cable Leads 4m, fittings
4.	T-5420	1842	Nozzle 1.0mm	NS	KT-1321	K.CP200.6M.CK.K	CP®200 Cable Leads 6m with centr. conn.
	T-5421	1843	Nozzle 1.3mm	NS	KT-1125	1234	CP®200 Mach. Torch with Leads 6m with centr. conn.
	T-5422	1844	Nozzle 1.6mm	NS	KT-1103	1234.10	CP®200 Mach. Torch with Leads 9m with centr. conn.
	T-5423	1845	Nozzle 1.8mm	NS	KT-1104	K.CP200.9M.CK.K	CP®200 Cable Leads 9m with centr. conn.

* FULLY INTERCHANGEABLE AND COMPATIBLE WITH ORIGINAL PARTS, BUT DIFFERS FROM ORIGINAL DESIGN
NS NOT SHOWN IN THE PICTURE

Last update of this page: 12/05/2020. See Revision history for details.

THERMACUT®
THE CUTTING COMPANY

WWW.THERMACUT.CZ
TEL.: +420 556 423 418
SALES@THERMACUT.CZ

WWW.THERMACUT.DE
TEL.: +49 (0) 27 39 40 33 0
INFO@THERMACUT.DE

WWW.THERMACUT.COM
TEL.: 1-603-542-6715
CUSTOMERSERVICE@THERMACUT.COM

THERMACUT®, THE CUTTING COMPANY®, FHT-EX®, EX-TRAFIRE®, EX-TRACK®, EX-TRABEAM® AND EX-TRAFAME® ARE REGISTERED TRADEMARKS OF THERMACUT, K.S. AND MAY BE REGISTERED IN CZECH REPUBLIC AND/OR OTHER COUNTRIES. ALL OTHER TRADEMARKS ARE PROPERTIES OF THEIR RESPECTIVE OWNERS. THERMACUT IS NO WAY AFFILIATED WITH CEBORA®.
MOST THERMACUT PARTS ARE MADE FOR OR BY AN IBG COMPANY. PARTS INDICATED WITH A OEM ARE ORIGINAL PARTS MANUFACTURED BY THE ABOVE NAMED MANUFACTURER AND ARE BEING RESOLD BY THERMACUT. THERMACUT RESERVES THE RIGHT TO SUBSTITUTE OEM PARTS IN PLACE OF THERMACUT PARTS.
VALID FROM NOVEMBER 2020 • PREVIOUS VERSION IS NO LONGER VALID. • © COPYRIGHT 2020 BY THERMACUT® CZECH REPUBLIC. ALL RIGHTS RESERVED.